



APPENDIX H: CRITICAL AREA PLAT

Prepared for:



Prepared by:



THE AREA SHOWN ON THIS PLAT IS A REPRESENTATION OF DEPARTMENT (SCDHEC OCRM) PERMIT AUTHORITY ON THE SUBJECT PROPERTY. CRITICAL AREAS BY THEIR NATURE ARE DYNAMIC AND SUBJECT TO CHANGE OVER TIME. BY DELINEATING THE PERMIT AUTHORITY OF SCDHEC OCRM, SCDHEC OCRM IN NO WAY WAIVES ITS RIGHT TO ASSERT PERMIT JURISDICTION AT ANY TIME IN ANY CRITICAL AREA ON THE SUBJECT PROPERTY, WHETHER SHOWN HEREON OR NOT.

Bradley J. Beebe
 SIGNATURE
 DATE 1/30/2023

The critical line shown on this plat is valid for five years from the date of this signature, subject to the cautionary language above.

WETLANDS

CAA	5.09 Ac.
CAB	5.53 Ac.
CAD	1.14 Ac.
CAE	4.98 Ac.
CAF	2.97 Ac.

TOTAL WETLANDS 19.65 Ac.
 TOTAL UPLAND IN STUDY AREA BOUNDARY 45377 Ac.
 TOTAL STUDY AREA 47342 Ac.

CURVE	RADIUS	LENGTH	DELTA	BEARING	DISTANCE
C1	1059.73'	431.08'	23°18'24" (RT)	N 89°28'35" E	428.17'
C2	1249.03'	388.33'	17°48'49" (LT)	S 84°28'41" W	386.77'
C3	2333.40'	1404.40'	34°46'58" (RT)	S 34°22'53" E	1382.94'
C4	1789.85'	1308.13'	41°55'19" (LT)	N 36°46'19" W	1272.15'
C5	800.00'	800.47'	57°19'45" (RT)	S 77°59'44" W	761.49'

LINE	BEARING	DISTANCE
L1	S 53°16'31" E	3038.48'
L2	N 64°58'26" E	128.69'
L3	S 55°20'24" E	992.32'
L4	N 36°28'53" E	194.35'
L5	S 53°25'12" E	2593.71'
L6	S 68°14'56" E	71.35'
L7	S 70°10'40" E	75.39'
L8	S 77°48'47" E	301.23'
L9	S 90°00'00" E	712.56'
L10	S 42°51'59" E	127.47'
L11	S 31°48'18" E	689.14'
L12	S 02°33'19" E	1213.46'
L13	S 18°41'46" E	2365.89'
L14	S 19°51'49" E	638.45'
L15	S 77°01'58" E	2886.84'
L16	N 69°31'00" E	959.59'
L17	S 14°21'13" E	950.38'
L18	N 77°41'22" E	655.89'
L19	S 09°45'39" W	390.82'
L20	S 78°04'56" W	467.19'
L21	S 64°47'04" W	986.90'
L22	S 12°30'39" E	461.92'
L23	S 49°26'30" E	758.05'
L24	S 57°11'40" E	602.22'
L25	S 67°14'49" W	665.30'
L26	N 58°51'07" W	541.27'
L27	N 59°27'37" W	281.52'
L28	N 67°08'15" W	282.38'
L29	N 71°58'08" W	78.82'
L30	S 73°18'23" W	630.19'
L31	S 80°10'27" W	853.62'
L32	S 76°11'30" W	390.27'
L33	S 107°28'22" W	142.25'
L34	S 26°17'39" W	234.29'
L35	S 80°31'35" W	156.23'
L36	N 47°47'24" W	274.70'
L37	S 55°05'05" W	1323.22'
L38	S 05°18'29" W	410.21'
L39	N 09°56'22" W	1843.58'
L40	N 16°37'32" E	2717.42'
L41	N 29°07'18" W	1697.95'
L42	N 36°42'22" E	226.88'
L43	N 53°57'13" W	596.60'
L44	N 13°52'40" E	741.58'
L45	N 33°15'36" W	3056.91'
L46	N 53°34'47" E	1094.51'

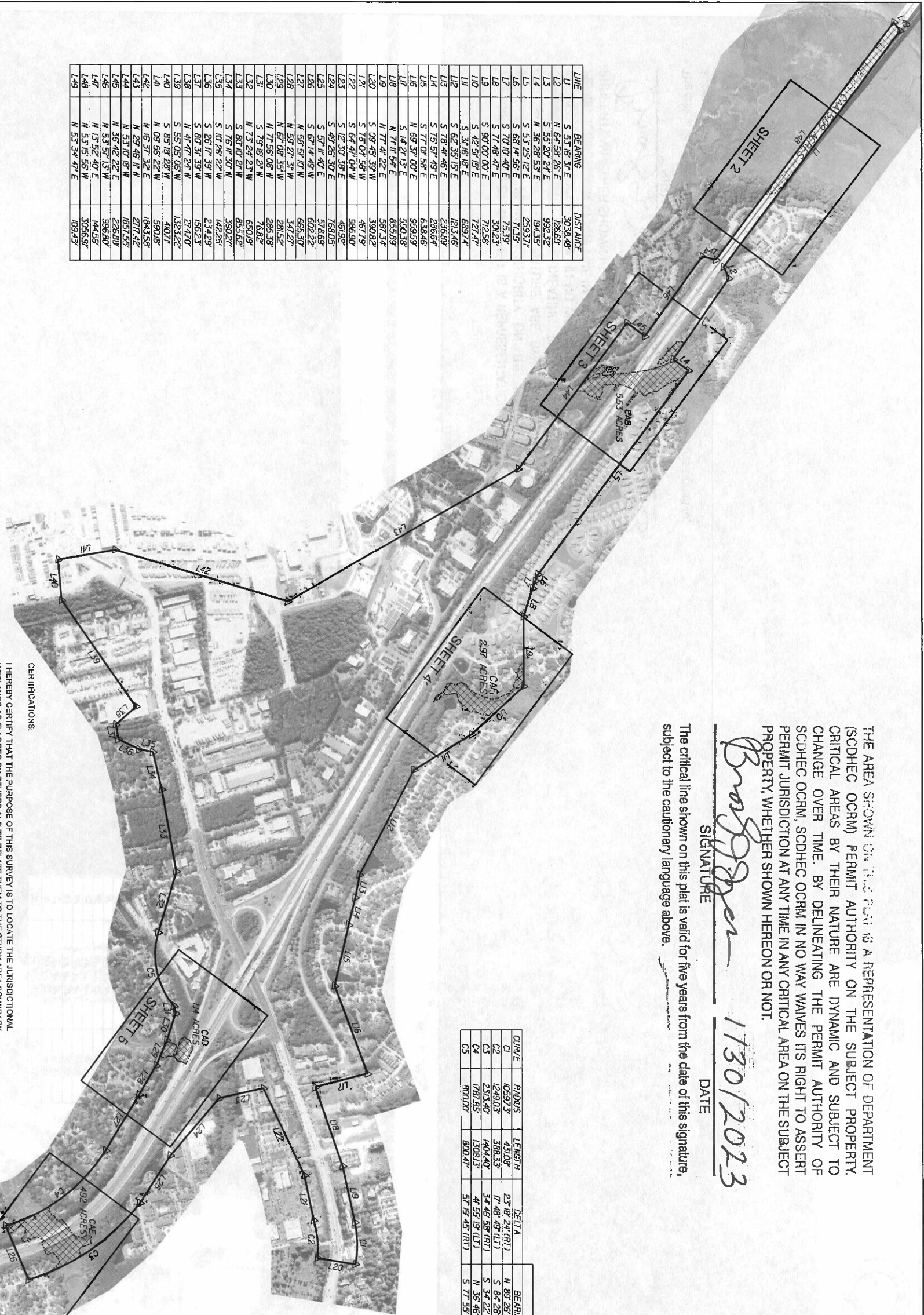

- SURVEYOR'S NOTES:
1. THE PURPOSE OF THIS SURVEY IS TO LOCATE THE JURISDICTIONAL WETLANDS AS FLAGGED BY THREE OAKS TO SHOW THEIR RELATIONSHIP TO THE STUDY AREA BOUNDARY.
 2. THE DISTANCES SHOWN HEREON ARE S.C. GRID DISTANCES. THE COMBINED SCALE FACTOR IS 0.98989508 TO REDUCE HORIZONTAL GROUND DISTANCES TO GRID DISTANCES.
 3. COORDINATES ARE S.C. STATE PLANE NAD83 (2011).

CERTIFICATIONS

I HEREBY CERTIFY THAT THE PURPOSE OF THIS SURVEY IS TO LOCATE THE JURISDICTIONAL WETLANDS AS FLAGGED BY OTHERS AND TO RELATE THEM TO THE STUDY AREA BOUNDARY AS SHOWN HEREON. THE JURISDICTIONAL WETLAND BOUNDARY LINES SHOWN WITH BEARINGS AND DISTANCES WERE SURVEYED. ALL OTHER INFORMATION HEREON IS SHOWN GRAPHICALLY AND IS FOR LOCATION PURPOSES ONLY.

THIS SURVEY MEETS THE REQUIREMENTS FOR A WETLAND SURVEY AS SPECIFIED IN THE STANDARDS OF PRACTICE MANUAL FOR SURVEYING IN SOUTH CAROLINA. THE PROJECT BOUNDARY TIES SHOWN HEREON MEETS THE REQUIREMENTS OF A CLASS 'A' SURVEY ACCURACY AS SPECIFIED THEREIN.

FOR ADDITIONAL CERTIFICATIONS AND COMMENTS SEE THE SURVEYOR'S NOTES STATED HEREON.



Daniel L. Beebe
 Daniel L. Beebe - South Carolina PLS # 31550

STUDY AREA BOUNDARY
 WETLAND LINE
 WETLAND AREA

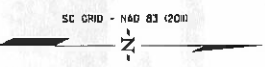
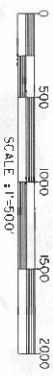

	GDM Smith 111/18/2022 111/18/2022
PROJECT NO. 222890 CLIENT: C. BEEBE SURVEYOR: S. WHITTLE	PLAT OF CRITICAL LINE SURVEY FOR THE STUDY AREA BOUNDARY OF PROPOSED LONG POINT ROAD AREA O.C.R.M./U.S.A.C.E.

LINE	BEARING	DISTANCE
A1	S 67°24'22"W	14.30'
A2	S 57°47'15"E	33.30'
A3	S 54°47'50"E	50.55'
A4	S 40°37'47"E	59.08'
A5	S 34°41'48"E	46.35'
A6	S 07°23'42"E	43.50'
A7	S 06°33'41"E	33.10'
A8	N 49°10'52"W	41.92'
A9	N 62°41'19"W	43.65'
A10	S 25°07'03"W	10.03'

S 53°16'31"E 3038.48' (TOT AL)
 S 53°16'31"E 1920.09'
 N 37°58'21.3 E 2343.44'48
 N 53°15'56"W 2120.88'
 N 53°15'56"W 3056.97' (TOT AL)
 N 53°15'56"W 936.02'
 S 53°16'31"E 1118.29'
 UPLAND 1
 15.24 ACRES
 CAA
 5.09 ACRES
 N 37°33'96.87 E 2341.87'07

THE AREA SHOWN ON THIS PLAT IS A REPRESENTATION OF DEPARTMENT (SDHEC OCRM) PERMIT AUTHORITY ON THE SUBJECT PROPERTY. CRITICAL AREAS BY THEIR NATURE ARE DYNAMIC AND SUBJECT TO CHANGE OVER TIME. BY DELINEATING THE PERMIT AUTHORITY OF SDHEC OCRM, SDHEC OCRM IN NO WAY WAIVES ITS RIGHT TO ASSERT PERMIT JURISDICTION AT ANY TIME IN ANY CRITICAL AREA ON THE SUBJECT PROPERTY, WHETHER SHOWN HEREON OR NOT.

Signature: *Brody Steyer*
 DATE: 1/30/2023
 The critical line shown on this plat is valid for five years from the date of this signature, subject to the cautionary language above.

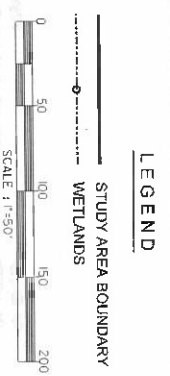
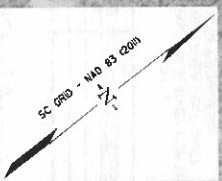

DATE	11/18/2022
BY	CDM SMITH
CHECKED	
DATE	
BY	
CHECKED	
DATE	
BY	

SEE SHEET 1 FOR SURVEYOR'S NOTES, FIELD CERTIFICATION & REFERENCES.
 S.C.P.L.S. NO. 31550
 COLE D. BEEBE



PROJECT NO. 2222890
 PREPARED FOR
OCRM/USACE
 CRITICAL LINE SURVEY FOR THE STUDY AREA BOUNDARY OF PROPOSED LONG FRONT ROAD AREA



LINE	BEARING	DISTANCE
B1	N 4°45'22"E	4.03'
B2	N 5°20'34"W	24.43'
B3	N 25°51'14"E	24.43'
B4	N 29°03'49"W	33.06'
B5	N 47°15'08"W	33.06'
B6	N 18°11'08"E	3.177'
B7	S 84°58'38"E	22.46'
B8	N 06°41'50"W	46.42'
B9	N 05°47'36"W	49.04'
B10	N 30°43'30"E	39.69'
B11	N 05°40'42"W	59.87'
B12	S 42°01'13"E	54.99'
B13	N 65°33'11"E	25.97'
B14	N 29°19'05"E	14.92'
B15	N 10°21'27"W	36.85'
B16	N 08°17'32"W	41.48'
B17	N 22°40'40"E	9.37'
B18	N 07°04'18"W	71.37'
B19	N 08°19'56"W	57.25'
B20	N 18°12'30"W	72.32'
B21	N 12°49'59"W	35.80'
B22	N 21°08'18"W	95.69'
B23	N 27°17'08"W	53.20'
B24	N 17°44'05"W	19.17'
B25	S 03°27'17"W	29.67'
B26	S 47°05'10"E	22.29'
B27	S 25°17'38"E	71.64'
B28	S 09°20'54"W	34.57'

THE AREA SHOWN ON THIS PLAT IS A REPRESENTATION OF DEPARTMENT (SODHEC OCRM) PERMIT AUTHORITY ON THE SUBJECT PROPERTY. CRITICAL AREAS BY THEIR NATURE ARE DYNAMIC AND SUBJECT TO CHANGE OVER TIME. BY DELINEATING THE PERMIT AUTHORITY OF SODHEC OCRM, SODHEC OCRM IN NO WAY WAIVES ITS RIGHT TO ASSERT PERMIT JURISDICTION AT ANY TIME IN ANY CRITICAL AREA ON THE SUBJECT PROPERTY, WHETHER SHOWN HEREON OR NOT.

Brian D. Beebe
 SUGMANN
 DATE 1/30/2023
 UPLAND 1, 1.524 ACRES.

The critical line shown on this plat is valid for five years from the date of this signature, subject to the cautionary language above.



LINE	BEARING	DISTANCE
B29	N 57°39'46"W	38.57'
B30	N 30°33'54"W	29.79'
B31	N 50°05'37"W	98.18'
B32	N 46°38'27"W	135.46'
B33	N 05°53'12"E	23.82'
B34	N 13°04'10"W	24.95'
B35	N 39°12'28"E	16.90'
B36	N 06°36'25"E	16.54'
B37	S 87°59'57"W	5.50'
B38	N 61°13'40"W	36.68'
B39	N 71°51'09"W	42.85'
B40	N 52°05'06"W	21.29'
B41	N 45°47'52"W	37.33'
B42	N 20°48'17"W	28.95'
B43	N 88°18'48"W	29.84'
B44	N 72°06'05"W	29.59'
B45	S 64°54'04"W	23.86'
B46	S 02°03'27"E	15.14'
B47	S 27°39'18"E	54.14'
B48	S 22°35'44"E	22.89'
B49	S 32°10'16"E	40.67'
B50	S 37°07'16"E	56.77'
B51	S 57°49'04"E	26.68'
B52	S 04°50'07"W	22.46'
B53	S 12°15'47"E	20.59'
B54	N 88°53'10"E	16.72'
B55	S 34°22'36"E	21.68'
B56	S 85°40'30"W	27.59'
B57	S 25°36'04"E	56.99'
B58	S 66°46'48"E	20.65'
B59	S 05°47'56"W	19.65'
B60	S 40°44'17"W	8.37'
B61	S 74°37'02"W	89.81'
B62	S 12°16'23"W	18.12'
B63	S 05°12'30"E	13.74'
B64	S 57°55'55"E	23.95'

SEE SHEET 1 FOR SURVEYOR'S NOTES, CERTIFICATION & REFERENCES.

Brian D. Beebe
 COLE D. BEEBE
 S.C.P.L.S. NO. 31550

LEGEND

STUDY AREA BOUNDARY

WETLANDS

SCALE 1"=50'

0 50 100 150 200

LINE	BEARING	DISTANCE
L50	N 53°10'18"W	63.79'
T10	N 69°20'32"E	47.39'
T12	N 03°07'35"W	25.04'
T13	N 07°27'44"W	26.66'

PROJECT NO. 222890

DATE 1/29

CLIENT S. WHITTLE

PROJECT 1729

DATE 11/18/2022

CRITICAL LINE SURVEY FOR THE STUDY AREA BOUNDARY OF PROPOSED LONG POINT ROAD AREA

OCRM/USACE

CDM Smith

LINE	BEARING	DISTANCE
B65	S 48°57'23"E	31.32'
B66	S 50°38'34"E	52.94'
B67	S 52°06'33"E	58.40'
B68	S 34°00'46"W	19.85'
B69	N 53°30'05"W	58.36'
B70	N 53°33'59"W	52.62'
B71	N 59°39'58"W	43.96'
B72	N 85°20'53"W	8.68'
B73	S 33°57'54"W	24.06'
B74	S 24°32'56"W	11.31'
B75	S 06°52'19"E	38.39'
B76	S 45°38'57"E	39.98'
B77	S 53°56'02"E	32.22'
B78	S 28°13'59"W	14.70'
B79	N 57°05'41"W	34.85'
B80	N 88°50'12"W	18.86'
B81	S 88°50'12"E	18.86'
B82	S 22°48'02"E	22.21'
B83	S 24°40'34"W	34.46'
B84	S 08°15'30"W	27.20'
B85	S 49°55'07"E	31.63'
B86	S 27°49'49"E	8.79'
B87	N 87°19'55"E	49.32'
B88	S 57°43'11"E	54.13'
B89	N 73°52'39"E	23.80'
B90	S 32°52'48"E	22.50'
B91	S 57°36'54"W	42.71'
B92	S 65°29'51"E	15.04'
B93	S 06°57'43"W	48.86'
B94	S 07°52'42"W	15.07'
B95	S 45°56'07"W	19.66'
B96	S 29°53'33"E	16.76'
B97	S 36°42'48"W	14.89'
B98	N 18°18'54"W	16.23'
B99	S 03°07'14"W	54.14'
B100	S 07°18'55"E	36.15'
B101	S 55°08'29"E	12.87'
B102	S 40°37'28"W	0.65'
B103	N 53°10'18"W	133.55'
B104	N 17°37'05"W	23.99'
B105	N 37°37'08"W	42.75'
B106	S 43°45'12"W	25.60'
B107	N 53°10'18"W	80.43'
B108	S 16°39'34"E	77.15'
B109	N 75°28'12"W	35.25'
B110	N 17°40'37"W	61.82'
B111	N 18°48'11"E	31.38'
B112	S 11°41'47"E	56.52'
B113	S 11°41'47"E	61.92'
B114	S 86°58'14"W	23.99'
B115	N 31°03'05"W	28.18'
B116	N 20°14'46"E	29.10'
B117	N 09°01'02"W	37.26'
B118	N 75°58'30"E	27.33'

LINE	BEARING	DISTANCE
L51	S 90° 00' 00" E	208.87'
L52	S 42° 51' 15" E	317.4'

LINE	BEARING	DISTANCE
F1	S 32° 28' 57" W	288.87'
F2	S 07° 06' 07" W	60.49'
F3	S 23° 55' 58" W	32.88'
F4	S 19° 48' 49" W	76.87'
F5	S 04° 18' 42" E	46.97'
F6	S 63° 40' 50" E	19.20'
F7	S 37° 50' 23" E	8.86'
F8	S 05° 17' 56" W	34.74'
F9	S 77° 04' 40" W	57.67'
F10	S 47° 31' 11" W	42.38'
F11	S 02° 22' 44" W	80.41'
F12	S 07° 29' 34" E	44.45'
F13	S 07° 29' 34" E	60.06'
F14	S 12° 01' 02" E	34.91'
F15	S 44° 10' 27" E	53.20'
F16	S 23° 59' 42" E	53.62'
F17	N 69° 21' 40" W	52.03'
F18	N 31° 27' 07" W	43.40'
F19	N 25° 46' 18" W	33.86'
F20	N 42° 55' 47" W	21.09'
F21	N 72° 33' 19" W	48.55'
F22	N 62° 46' 11" W	41.87'
F23	N 07° 10' 23" W	44.41'
F24	N 307° 08' 58" E	33.44'
F25	N 05° 18' 05" W	12.23'
F26	N 16° 38' 15" W	37.44'
F27	N 28° 43' 59" W	21.43'
F28	N 207° 36' 32" E	49.09'
F29	N 54° 57' 20" E	61.07'
F30	N 36° 48' 17" E	78.27'
F31	N 19° 41' 31" E	85.87'
F32	N 21° 31' 30" E	69.03'
F33	N 00° 46' 34" E	46.13'
F34	N 14° 20' 46" W	57.28'
F35	N 29° 02' 53" W	47.51'
F36	N 18° 49' 03" W	61.32'
F37	N 66° 16' 43" W	31.05'
F38	N 63° 11' 49" W	11.85'
F39	N 17° 53' 21" W	29.39'
F40	S 85° 57' 37" W	15.97'
F41	S 39° 50' 57" W	14.09'
F42	N 67° 40' 09" W	42.81'
F43	N 65° 44' 04" W	61.45'
F44	N 80° 16' 53" W	49.59'
F45	N 72° 03' 42" W	64.50'
F46	N 55° 49' 30" W	39.16'
F47	S 90° 00' 00" E	16.09'
F48	S 69° 44' 04" E	56.70'
F49	N 10° 14' 21" E	39.53'
F50	N 03° 28' 31" E	46.54'
F51	S 81° 06' 23" E	56.53'
F52	S 62° 18' 53" E	34.98'
F53	S 07° 40' 19" W	51.79'
F54	S 07° 40' 19" W	11.93'
F55	N 807° 19' 03" E	50.41'
F56	N 07° 31' 35" E	50.41'

THE AREA SHOWN ON THIS PLAT IS A REPRESENTATION OF DEPARTMENT (SCDHC OCRM) PERMIT AUTHORITY ON THE SUBJECT PROPERTY. CRITICAL AREAS BY THEIR NATURE ARE DYNAMIC AND SUBJECT TO CHANGE OVER TIME. BY DELINEATING THE PERMIT AUTHORITY OF SCDHC OCRM, SCDHC OCRM IN NO WAY WAIVES ITS RIGHT TO ASSERT PERMIT JURISDICTION AT ANY TIME IN ANY CRITICAL AREA ON THE SUBJECT PROPERTY, WHETHER SHOWN HEREON OR NOT.

SIGNATURE: *C. Beebe*
 DATE: 11/30/2023

The critical line shown on this plat is valid for five years from the date of this signature, subject to the cautionary language above.



SEE SHEET 1 FOR SURVEYOR'S NOTES, CERTIFICATION & REFERENCES
 COLE D. BEEBE
 S.C.P.S. NO. 31550



C. BEEBE S. WHITTE 1729 222890	PLAT OF CRITICAL LINE SURVEY FOR THE STUDY AREA BOUNDARY OF PROPOSED LONG POINT ROAD AREA O.C.R.M./U.S.A.C.E.	GPM Smith 11/18/2022
---	--	----------------------------



LEGEND
 STUDY AREA BOUNDARY
 WETLANDS

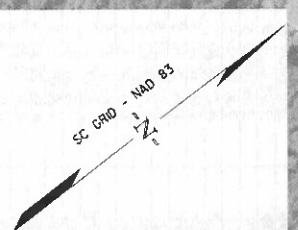

THE AREA SHOWN ON THIS PLAT IS A REPRESENTATION OF DEPARTMENT (SCDHEC OCRM) PERMIT AUTHORITY ON THE SUBJECT PROPERTY. CRITICAL AREAS BY THEIR NATURE ARE DYNAMIC AND SUBJECT TO CHANGE OVER TIME. BY DELINEATING THE PERMIT AUTHORITY OF SCDHEC OCRM, SCDHEC OCRM IN NO WAY WAIVES ITS RIGHT TO ASSERT PERMIT JURISDICTION AT ANY TIME IN ANY CRITICAL AREA ON THE SUBJECT PROPERTY, WHETHER SHOWN HEREON OR NOT.

Brad Spiller
 SIGNATURE DATE 1/30/2023

The critical line shown on this plat is valid for five years from the date of this signature, subject to the cautionary language above.

CURVE	RADIUS	LENGTH	DELTA	BEARING	CHORD	DISTANCE
C5	800.00'	800.47'	57°19'45"(R/L)	S 77°55'44" W	767.49'	767.49'

LINE	BEARING	DISTANCE
L31	S 79°16'27" W	76.82'

LINE	BEARING	DISTANCE
D1	N 03°10'07" E	31.56'
D2	N 09°21'02" E	40.23'
D3	N 31°50'29" E	46.45'
D4	S 69°51'61" E	111.02'
D5	N 27°20'15" W	36.61'
D6	N 77°37'05" W	102.31'
D7	N 71°34'18" W	54.23'
D8	N 30°36'28" W	50.05'
D9	N 31°41'11" E	34.42'
D10	N 25°57'28" E	21.37'
D11	N 65°22'19" E	6.667'
D12	S 89°42'40" E	4.217'
D13	S 65°22'01" E	156.44'
D14	S 35°56'52" W	15.34'
D15	S 23°35'28" W	41.39'
D16	S 07°57'29" W	37.41'
D17	S 57°11'46" W	44.51'
D18	S 19°14'00" W	28.84'
D19	S 06°06'18" W	41.80'
D20	S 23°02'56" E	30.49'
D21	S 00°14'47" E	33.49'
D22	S 35°29'04" W	28.28'
D23	N 67°08'35" W	146.68'

LINE	BEARING	DISTANCE
L33	N 67°08'35" W	106.57'
L34	N 67°08'35" W	26.27'



SEE SHEET 1 FOR SURVEYOR'S NOTES, CERTIFICATION & REFERENCES.
Brad Spiller
 COLE D. BEEBE S.C.P.L.S. NO. 31950



PROJECT NO. 222890
 DATE 1/29
 SURVEYOR C. BEEBE
 CLIENT S. WHITTLE
 PLAT OF CRITICAL LINE SURVEY FOR THE STUDY AREA BOUNDARY OF PROPOSED LONG POINT ROAD AREA O.C.R.M./U.S.A.C.E.
 DATE 11/18/2022



LEGEND
 STUDY AREA BOUNDARY
 WETLANDS

THE AREA SHOWN ON THIS PLAT IS A REPRESENTATION OF DEPARTMENT (SCDHEC OCRM) PERMIT AUTHORITY ON THE SUBJECT PROPERTY. CRITICAL AREAS BY THEIR NATURE ARE DYNAMIC AND SUBJECT TO CHANGE OVER TIME. BY DELINEATING THE PERMIT AUTHORITY OF SCDHEC OCRM, SCDHEC OCRM IN NO WAY WAIVES ITS RIGHT TO ASSERT PERMIT JURISDICTION AT ANY TIME IN ANY CRITICAL AREA ON THE SUBJECT PROPERTY, WHETHER SHOWN HEREON OR NOT.

Bradford
 SIGNATURE
 DATE 1/30/2023

The critical line shown on this plat is valid for five years from the date of this signature, subject to the cautionary language above.

LINE	BEARING	DISTANCE
E1	N 42° 40' 22" E	3.85
E2	N 52° 25' 42" E	2.12
E3	N 75° 35' 40" E	21.16
E4	N 54° 18' 20" E	33.34
E5	N 13° 31' 46" E	18.40
E6	N 57° 41' 09" E	48.54
E7	N 15° 45' 02" E	27.95
E8	N 19° 27' 10" W	29.89
E9	N 48° 53' 07" E	41.69
E10	N 52° 12' 22" E	64.59
E11	N 70° 25' 30" E	14.16
E12	N 40° 57' 42" E	16.20
E13	N 52° 56' 30" E	69.54
E14	N 33° 42' 22" E	17.92
E15	N 17° 02' 00" E	61.50
E16	N 02° 21' 00" W	19.18
E17	N 08° 50' 14" W	36.87
E18	N 11° 01' 46" E	12.08
E19	N 09° 34' 00" E	40.92
E20	S 77° 25' 18" E	52.48
E21	N 88° 19' 33" E	7.57
E22	N 25° 17' 34" E	18.10
E23	S 25° 37' 05" E	48.59
E24	S 7° 49' 34" E	49.80
E25	S 13° 50' 13" E	24.39
E26	S 62° 44' 53" E	16.08
E27	S 04° 10' 45" E	13.34
E28	N 81° 58' 22" E	43.72
E29	N 64° 20' 09" E	34.87
E30	S 62° 53' 06" W	8.16
E31	N 45° 12' 17" W	76.53
E32	N 50° 41' 55" W	26.02
E33	S 82° 01' 33" W	33.48
E34	S 48° 42' 21" W	59.18
E35	S 50° 48' 50" W	39.39
E36	S 25° 11' 20" E	60.09
E37	S 49° 46' 28" W	22.20
E38	S 61° 46' 28" W	14.47
E39	N 44° 56' 21" W	31.35
E40	S 31° 42' 45" W	60.85
E41	S 10° 34' 31" E	20.97
E42	S 23° 29' 34" W	17.37
E43	S 23° 22' 09" E	21.45
E44	S 25° 48' 58" E	35.46
E45	S 19° 35' 09" E	62.89
E46	S 21° 00' 45" W	22.00
E47	S 75° 55' 41" W	24.52
E48	N 44° 00' 43" W	27.58
E49	N 68° 15' 24" W	49.29
E50	S 88° 09' 46" W	45.13
E51	S 29° 30' 18" W	58.38
E52	S 50° 07' 41" E	42.58
E53	S 25° 37' 54" E	38.38
E54	S 12° 28' 20" E	57.11
E55	S 38° 28' 28" E	14.03
E56	S 28° 46' 42" W	35.26
E57	S 67° 14' 49" W	35.26
E58	N 40° 37' 24" W	2.44
E59	N 55° 08' 30" W	43.76
E60	N 49° 49' 54" W	24.58

CURVE	RADIUS	LENGTH	DELTA	BEARING	DISTANCE
C3	2313.40'	1404.40'	34° 46' 58" (RT)	S 34° 22' 53" E	1382.94'
C4	1787.85'	1308.13'	41° 55' 15" (LT)	N 35° 46' 19" W	1279.15'
C5	2313.40'	812.57'	20° 07' 24" (RT)	S 41° 42' 40" E	800.34'
C6	2313.40'	329.94'	8° 07' 19" (RT)	S 27° 55' 19" E	322.66'
C7	2313.40'	283.95'	5° 32' 15" (RT)	S 20° 15' 32" E	263.82'
C8	2313.40'	283.95'	5° 32' 15" (RT)	N 16° 47' 28" W	61.77'
C9	1787.85'	611.1'	13° 44' 31" (LT)	N 24° 23' 35" W	412.33'
C10	1787.85'	413.25'	13° 44' 31" (LT)	N 24° 23' 35" W	412.33'
C11	1787.85'	833.71'	26° 43' 05" (LT)	N 44° 22' 25" W	828.18'

LINE	BEARING	DISTANCE
L55	S 67° 14' 49" W	42.42'

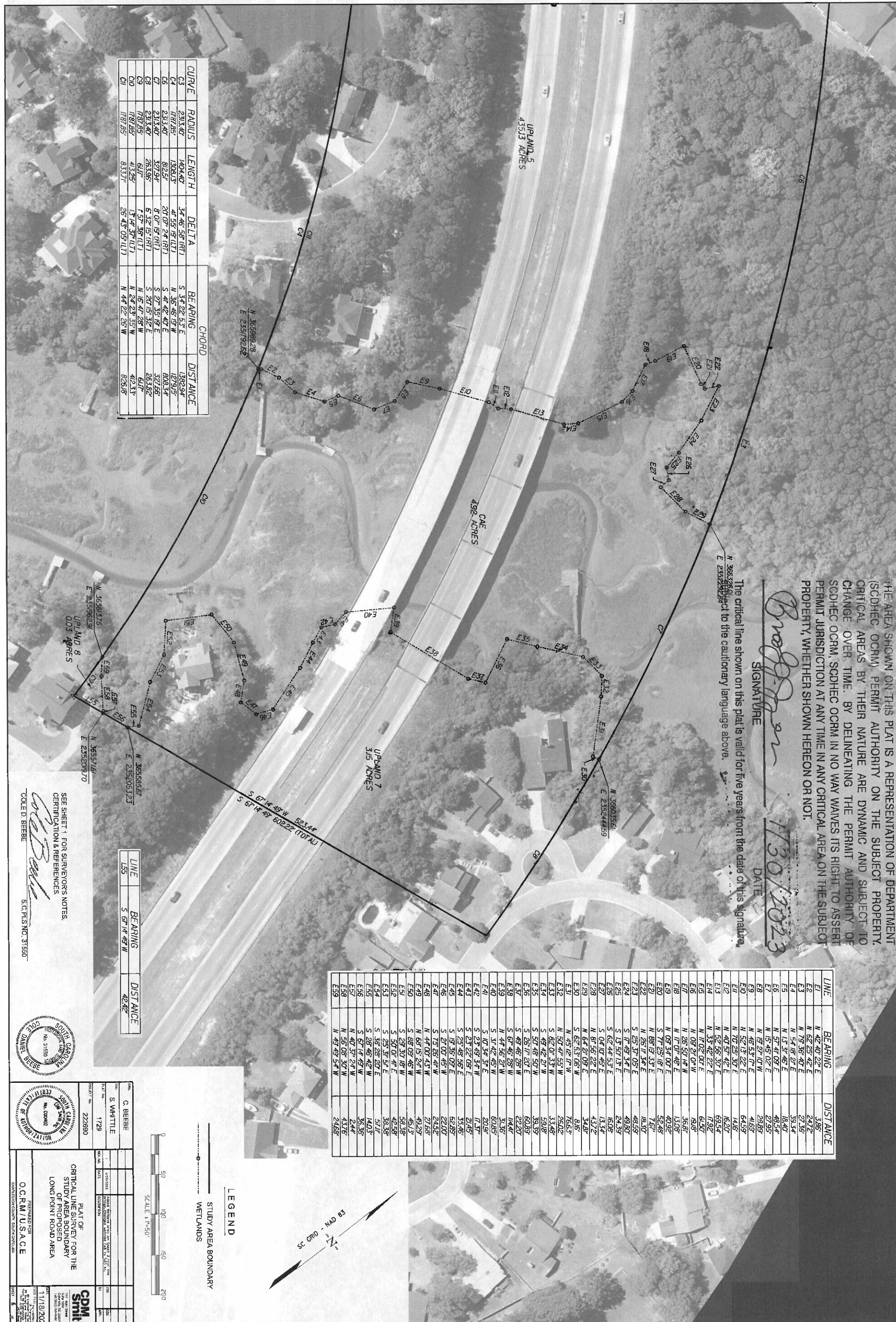

SEE SHEET 1 FOR SURVEYOR'S NOTES, CERTIFICATION & REFERENCES.

COLE D. BEEBE
 S.C.P.L.S. NO. 31560

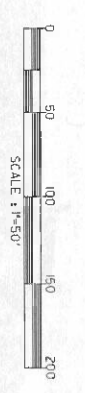

LEGEND
 STUDY AREA BOUNDARY
 WETLANDS

PLAT OF CRITICAL LINE SURVEY FOR THE STUDY AREA BOUNDARY OF PROPOSED LONG POINT ROAD AREA O.C.R.M./U.S.A.C.

11/18/2022

CDM Smith